

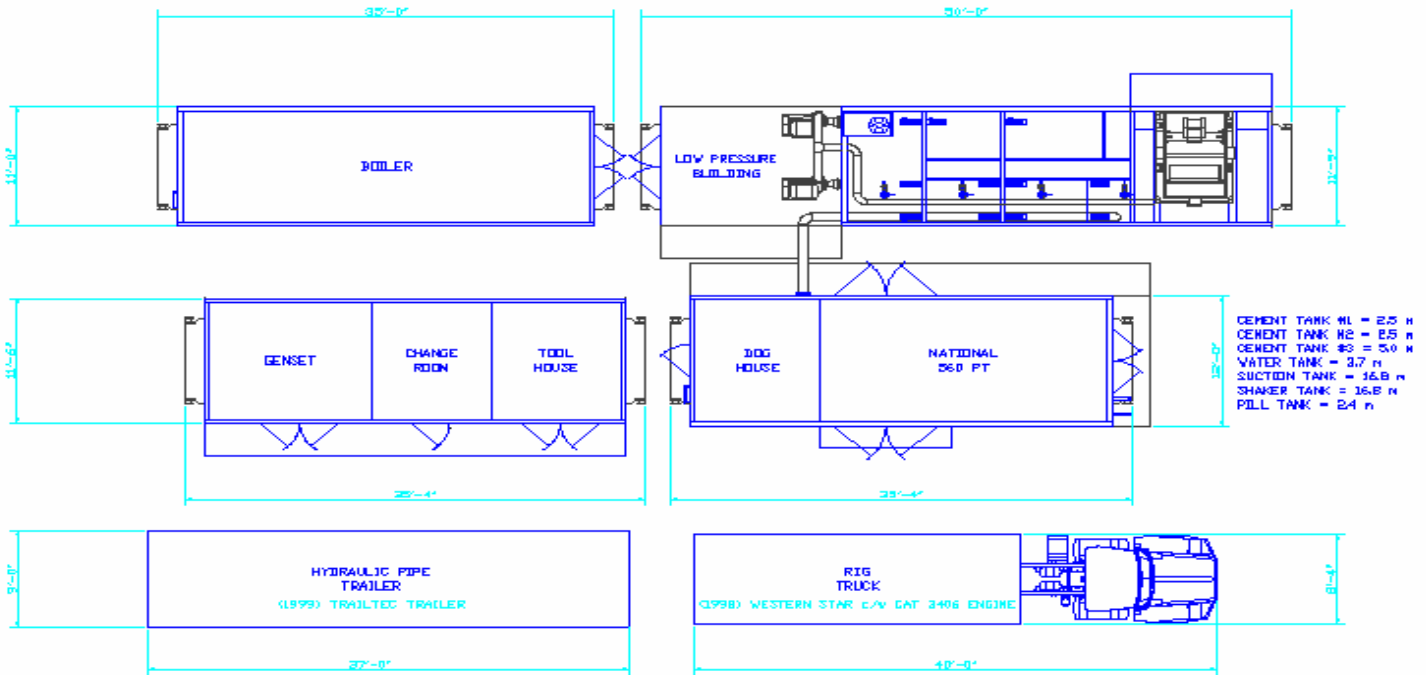

## RIG 401 OVERVIEW



### Drawworks

Make - Foremost  
 Model - 240  
 Hoisting Capacity - 37,300 daN  
 Pull Down - 12,000 daN

### Carrier

Make - Foremost/Western Star  
 Model - Explorer II  
 Output Power - 3406 - 373kw

### Rig Power

Make - Caterpillar  
 Model - 3306  
 Output Power - 200kw

### Substructure

Capacity - L-16.8 X W-3.66 X H1.7m  
 65,000daN

### Mast

Capacity - 37,300 daN

### Mud Pump

Make - National Oilwell  
 Model - 560 PT Triplex  
 Drive - 3408 Cat, Allison Transmission  
 and 5X6X10 precharge pump

### Mud System

Total Volume - 46m3  
 Active Volume - 40m3  
 Compartments - 5  
 Mixing - 2-5X6 Mission 37kw pumps

### Shale Shaker

Make - Brandt  
 Model - Double Deck

### Top Drive

Make - Foremost  
 Model - 240  
 RPM - 150  
 Torque - 12,000 FT. LBS

### BOP Stack

Size - N/A  
 Rating - Surface Rig

### Accumulator - N/A

Surface Rig

### Choke Manifold - N/A

Surface Rig

### Boiler

Make - Dupre  
 Model - 100 H.P.  
 Fresh Water Tank - 12.7 m3  
 Fuel Tank - 5000 litre

### Fuel Tank - 10,000 litres

### Water Tank - 4m3

### Tubulars

Drill Pipe - 127mm 4" F.H.  
 Collars - 152mm 4" F.H.

### Special Features

Cementing Capabilities  
 Dual hydraulic breakout tong system  
 Pason EDR  
 Handle up to 508mm casing  
 Articulating Top Drive  
 Pipe Handling  
 Power Tongs for Casing, not required  
 Substructure available if diverter  
 required for surface

**Rated Depth 500 meters**

**No. of Loads (winter) 5**